

GEORGETOWN ROAD

RETAIL DEVELOPMENT

1803 GEORGETOWN RD, LEXINGTON, KY 40511



SITE PLAN

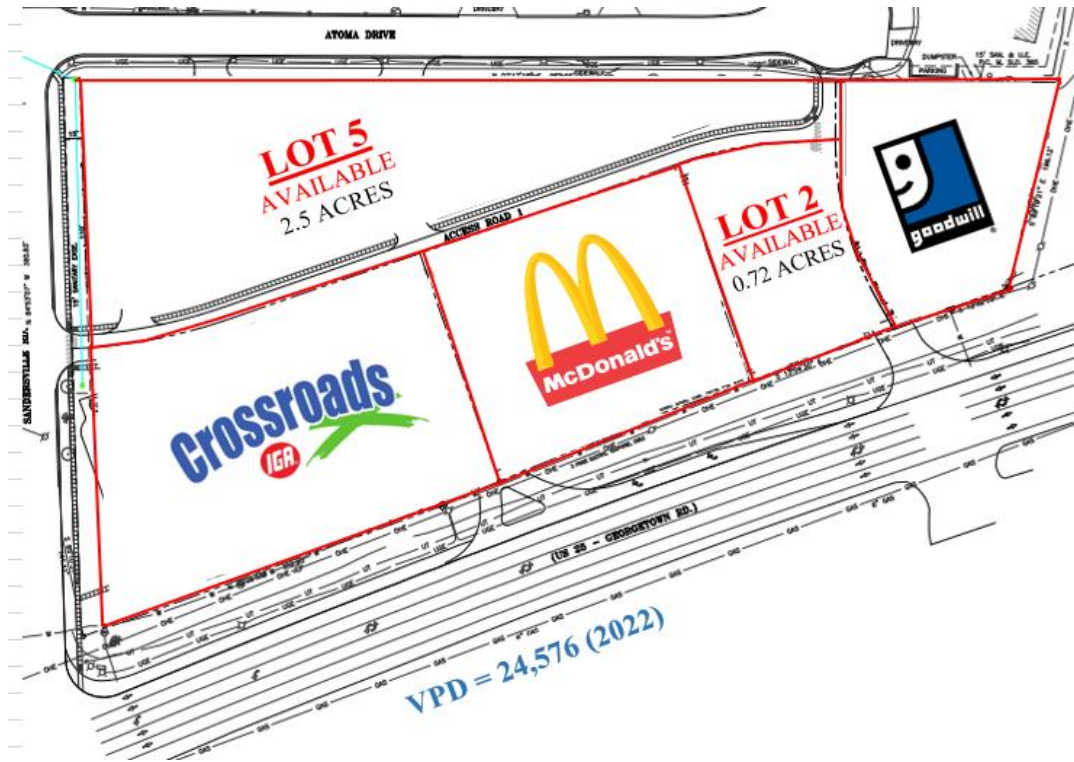

Lot 1

Goodwill - Drop Off Site

Lot 2

AVAILABLE

0.72 Acres

Drive-Thru Capabilities Available

Lot 3

McDonald's

Lot 4

Crossroads IGA - Shell & Subway

Lot 5

AVAILABLE

2.5 Acres

6,000 SF Building

12,000 SF Building

18,000 SF Building

Drive-Thru Capabilities Available

New Publix/Shopping Center Development



- .4 miles S of a newly announced Publix.
- .6 Miles S of Citation Centre, a planned \$60 million mixed-use development on 28 acres. The development is planned to feature a national grocery, retail, restaurants, professional offices, and medical facilities.

Lot 2 - Outparcel



Location

- ★ Subject Property
- 1 Citation Centre
- 2 New Publix
- 3 Sanders Garden-Ball Homes
- 4 Future SFR - Ball Homes
- 5 New Circle Rd - Beltway
- 6 Lexington CBD
- 7 Interstate 64/75 Interchange

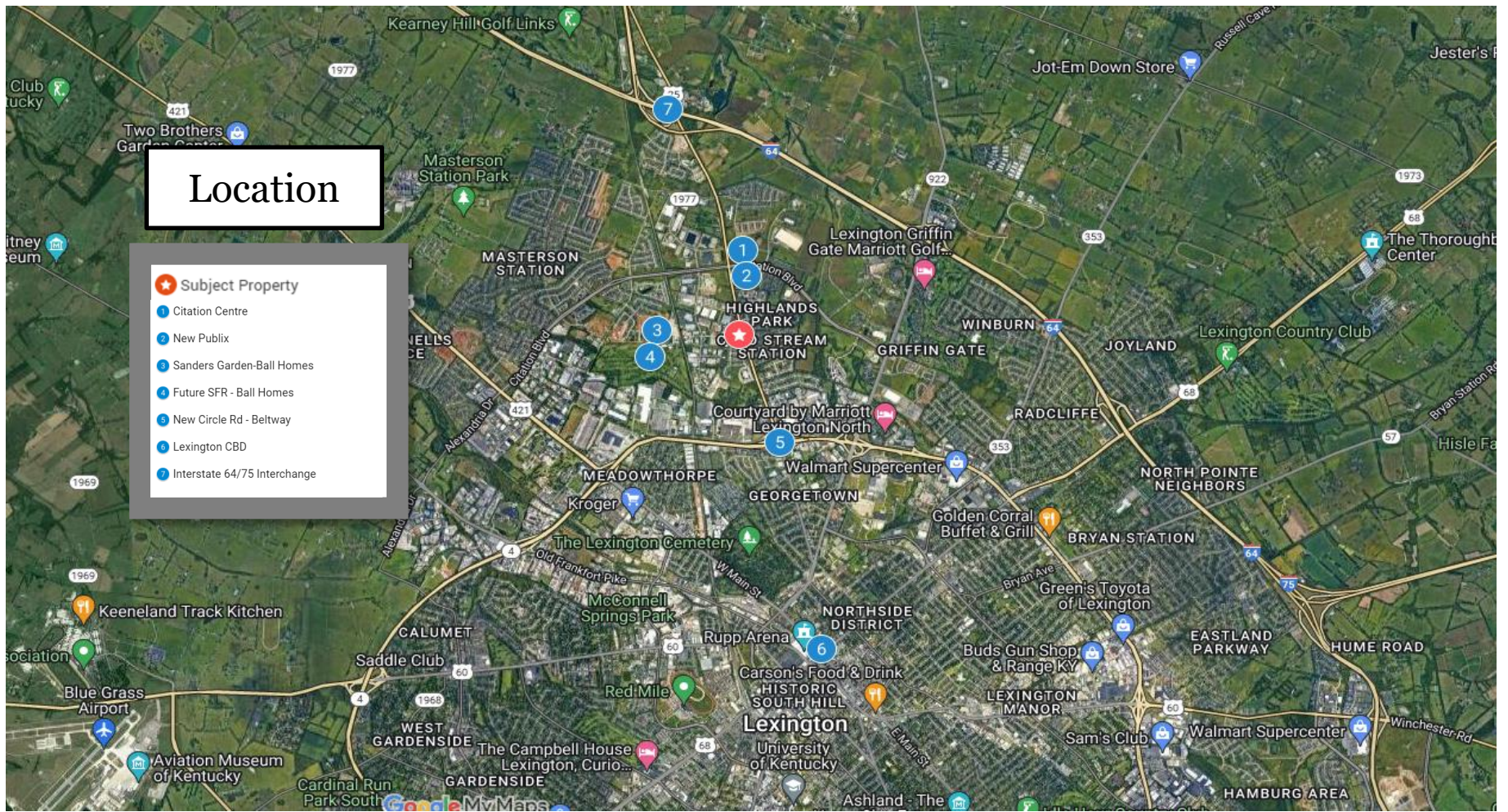

NEW RESIDENTIAL DEVELOPMENT

2,000+ Beds, COMPLETED 2023



Ball Homes is developing 200+ additional acres of high-density multi-family and single-family homes within 1/2 mile of the site (Housing 4,000+ new residents)

2,000+ Beds, Future Development